

## Connecting comb tires

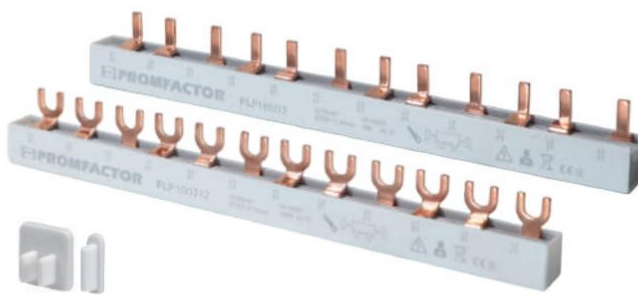

### Specifications

Type	FRF	FLF	FRP	FLP
Compliance with the standard	EN 60947-7-1			
Type	FORK		PIN	
Number of poles	1R	3R	1R	3R
Cross section of tires, <sup>2</sup>	10/16			
mm Number of modules	12-mod, 54-mod 18			
Pitch, mm				
Nominal current I <sub>n</sub> , A	10 mm <sup>2</sup>		63	
	16 mm <sup>2</sup>		100	
Nominal insulation voltage U <sub>ÿ</sub> , V Dielectric strength, kV			500	
Insulation resistance, Mÿ			2.5	
Degree of protection			>5	
Operating position			Any	
			IP20	

### Overall dimensions

#### FRF 1P

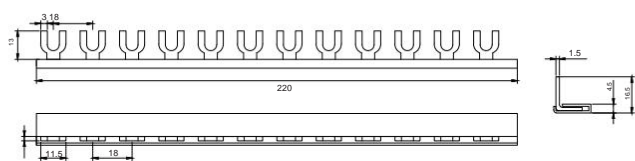

#### FRP 1P

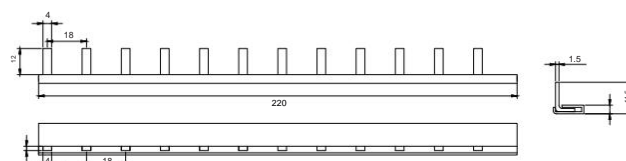

#### FLF 3P

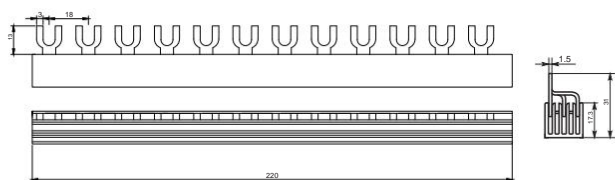

#### FLP 3P

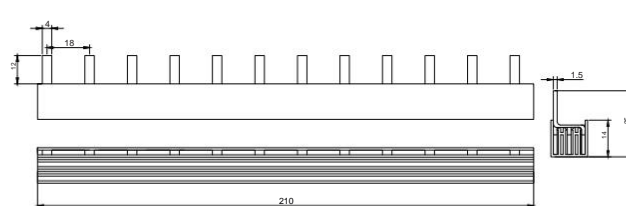

## Comb connecting tires FORK, PIN

PIN type	Code order	Full name	Packaging, pcs		Gross weight, kg		
			Packaging Box	Unit Packaging Box			
	FLP100354	Comb bus FLR 10mm2 3P 63A 54 modules PIN type	5	50	0.480	2,400	24,000
	FLP100312	FLR 10mm2 63A 3P 12-module PIN-type comb busbar	20	200	0.095	1,900	19,000
	FLP160312	Comb bus FLR 16mm2 100A 3P 12 modules PIN type	20	200	0.130	2,600	26,000
	FLP160354	Comb bus FLR 16mm2 100A 3P 54 modules PIN type	5	50	0.640	3,200	32,000
	FRP100112	FRP comb busbar 10mm2 63A 1P 12 modules PIN type	40	200	0.037	1,480	7,400
	FRP100154	FRP comb bus bar 10mm2 63A 1P 54 modules PIN type	5	100	0.170	0,850	17,000
	FRP160112	FRP comb busbar 16mm2 100A 1P 12 modules PIN type	40	200	0.060	2,400	12,000
	FRP160154	FRP comb bus bar 16mm2 100A 1P 54 modules PIN type	5	100	0.250	1,250	25,000
Type FORK	FLF100354	Comb busbar FLF 10mm2 63A 3P 54 modules type FORK	5	50	0.480	2,400	24,000
	FLF100312	Comb busbar FLF 10mm2 63A 3P 12 modules type FORK	20	200	0.100	2,000	20,000
	FLF160312	Comb busbar FLF 16mm2 100A 3P 12 modules type FORK	20	200	0.130	2,600	26,000
	FLF160354	Comb busbar FLF 16mm2 100A 3P 54 modules type FORK	5	50	0.680	3,400	34,000
	FRF100112	Comb busbar FRF 10mm2 63A 1P 12 modules type FORK	40	200	0.053	2,120	10,600
	FRF100154	Comb bus FRF 10mm2 63A 1P 54 module type FORK	5	100	0.220	1,100	22,000
	FRF160112	Comb busbar FRF 16mm2 100A 1P 12 modules type FORK	40	200	0.065	2,600	13,000
	FRF160154	Comb busbar FRF 16mm2 100A 1P 54 modules type FORK	5	100	0.280	1,400	28,000
Side plugs	EC1003	Side cap for FLF 3P 10mm2 comb busbar				0	0
	EC1603	Side plug for FLF 3P 16mm2 comb busbar				0	0
	EC1001	Side cap for FRF 1P 10mm2 comb busbar				0	0
	EC1601	Side cap for FRF 1P 16mm2 comb busbar				0	0

## Adapter F/AD, F/ADS

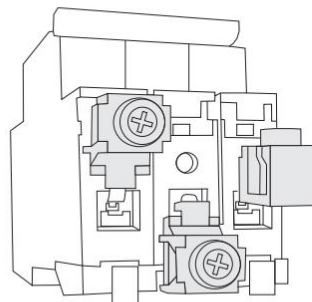

An adapter for side and top connection is used when connecting wires

section up to 25 mm<sup>2</sup>.

It is possible to connect to automatic switches **FB1-63**, **FB2-63**, **FB3-63**.

## Overall dimensions

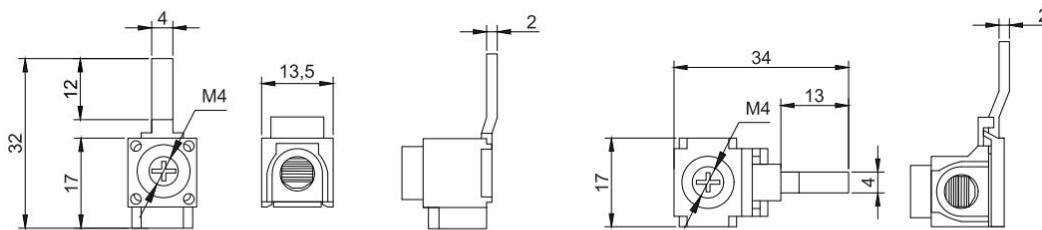

Code order	Full name
F/AD	Adapter for top connection F/AD
F/ADS	Adapter for F/ADS side connection